

PRODUCT DATA

DUO BOX Mod. PARK 03

Semiautomatic system for independent car parking consisting of flanking modules formed by 3 platforms each.

The steel parking platforms are arranged on 3 levels. The upper and lower platforms move vertically while the ones at street level move horizontally.

At street level there is always a free zone the size of a carport so the platform at that level can move horizontally in order to let the lower platform rise and the upper one descend.

Construction and assembly details

The steel structure assembled in the shaft consists of steel guides for the vertical running of the lower platform and tracks for the transversal sliding of the street level platform.

The platforms comprise longitudinal and transversal elements, adjustable wheel chocks and other small elements assembled with bolts.

The system for raising the platforms consists of hydraulic cylinders with electro-hydraulic valves, cogs, chains and end of stroke switches. The street level platforms move transversally on guides and are activated by chains and wheels.

Power unit

The system is equipped with a hydraulic unit whose task is to move the plant cylinders by means of hydraulic fluid. The fluid activating systems are electromechanical and fully managed by the electrical system. Power is delivered by a three-phase asynchronous electric motor AC 3 kW, 400 V / 50 Hz.

Reliability of the hydraulic system is guaranteed by a series of valves, in particular by the flow control valves at the base of the jacks and a maximum pressure valve on the hydraulic system distributor within the fluid tank.

Control system

The car park is controlled by a command panel and by a PLC which, by means of a programme, manages the functioning of the entire plant.

Movements of the platforms are selected by means of an electronic card assigned to each car space, or by remote control.

**PRODUCT
DATA**

Safety

In front of each grille there is a gate which opens manually or is motorised with person present functioning.

Payload: 2000/2500 Kg per car space

Shaft measurements: see technical data

Platform measurements: see technical data

Height of space: see technical data

Landing: see technical data

PRODUCT DATA

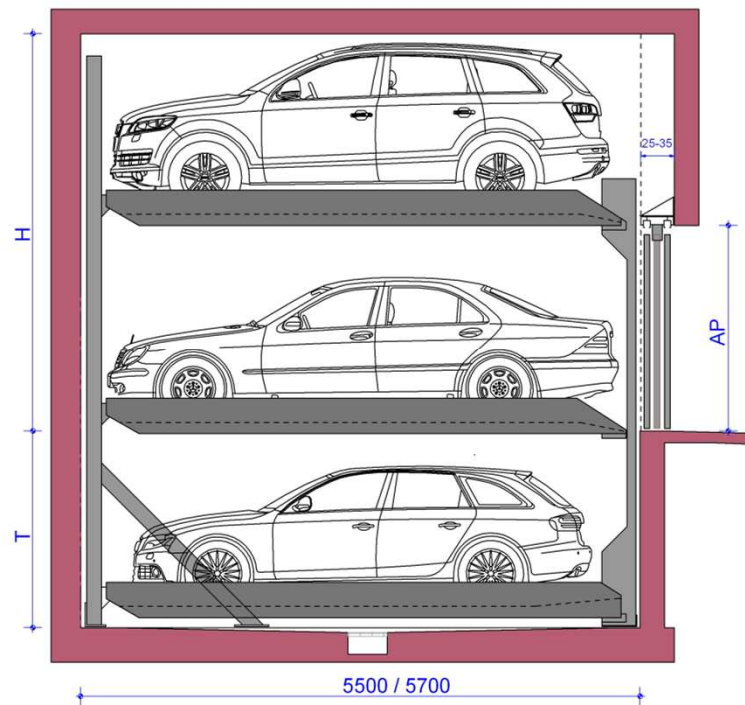

Model	T	H	AP	Car height lower	Car height entrance	Car height upper
PARK 03 – 175	1750	3450	2200	1500	1700	1500
PARK 03 – 175	1750	3650	2200	1500	1900	1500
PARK 03 – 175	1750	3800	2300	1500	2050	1500
PARK 03 – 200	2000	3750	2200	1750	1750	1750
PARK 03 – 200	2000	4050	2300	1750	2050	1750
PARK 03 – 230	2300	4350	2300	2050	2050	2050

**PRODUCT
DATA**

**PRODUCT DATA
DUO BOX Mod. PARK 03**

Pit width	Usable platform width
2500	2300
2600	2400
2700	2500
2800	2600
2900	2700

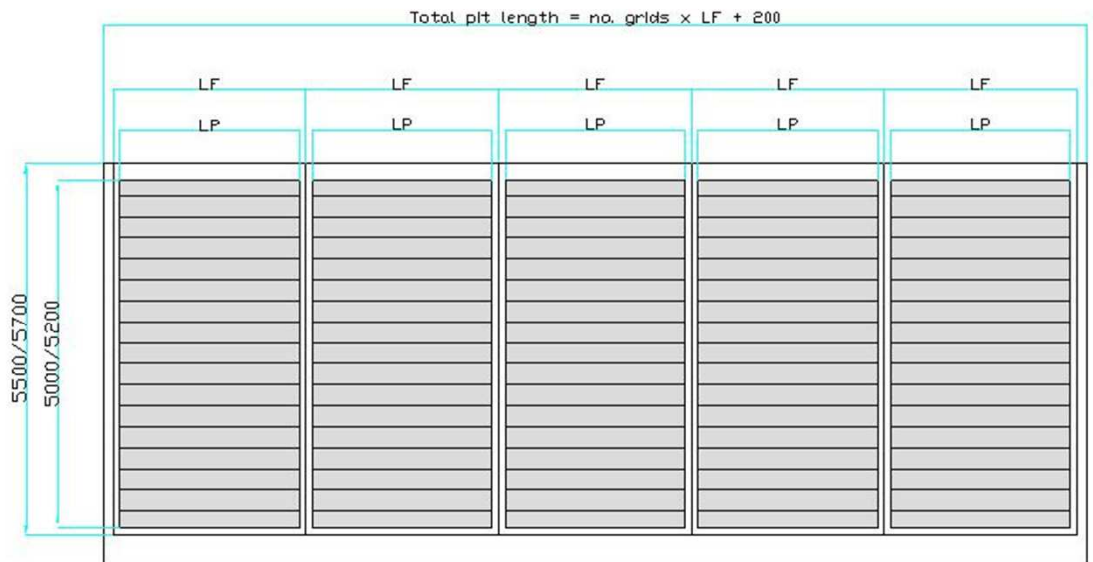

LF: Pit width

LP: Usable platform width

PHOTOS



ACCESSORIES

