

**PRODUCT
DATA****DUO BOX Mod. PARK 02**

Semiautomatic system for independent car parking consisting of flanking modules formed by 2 platforms each, one at street level and one above.

The solid steel parking platforms are in fact set on two levels. The upper platforms move vertically while those at street level move horizontally.

At street level there is always a free zone the size of a carport so the platform at that level can move horizontally in order to let the lower platform rise.

Construction and assembly details

The steel structure assembled in the shaft consists of steel guides for the vertical running of the lower platform and tracks for the transversal sliding of the street level platform.

The platforms comprise longitudinal and transversal elements, adjustable wheel chocks and other small elements assembled with bolts.

The system for raising the platforms consists of hydraulic cylinders with electro-hydraulic valves, cogs, chains and end of stroke switches. The street level platforms move transversally on guides and are activated by chains and wheels.

Power unit

The system is equipped with a hydraulic unit whose task is to move the plant cylinders by means of hydraulic fluid. The fluid activating systems are electromechanical and fully managed by the electrical system. Power is delivered by a three-phase asynchronous electric motor AC 3 kW, 400 V / 50 Hz.

Reliability of the hydraulic system is guaranteed by a series of valves, in particular by the flow control valves at the base of the jacks and a maximum pressure valve on the hydraulic system distributor within the fluid tank.

Control system

The car park is controlled by a command panel and by a PLC which, by means of a programme, manages the functioning of the entire plant.

Movements of the platforms are selected by means of an electronic card assigned to each car space, or by remote control.

**PRODUCT
DATA**

Safety

In front of each grille there is a gate which opens manually or is motorised with person present functioning.

Payload: 2000/2500 Kg per car space

Shaft measurements: see technical data

Platform measurements: see technical data

Height of space: see technical data

Landing: see technical data

PRODUCT DATA

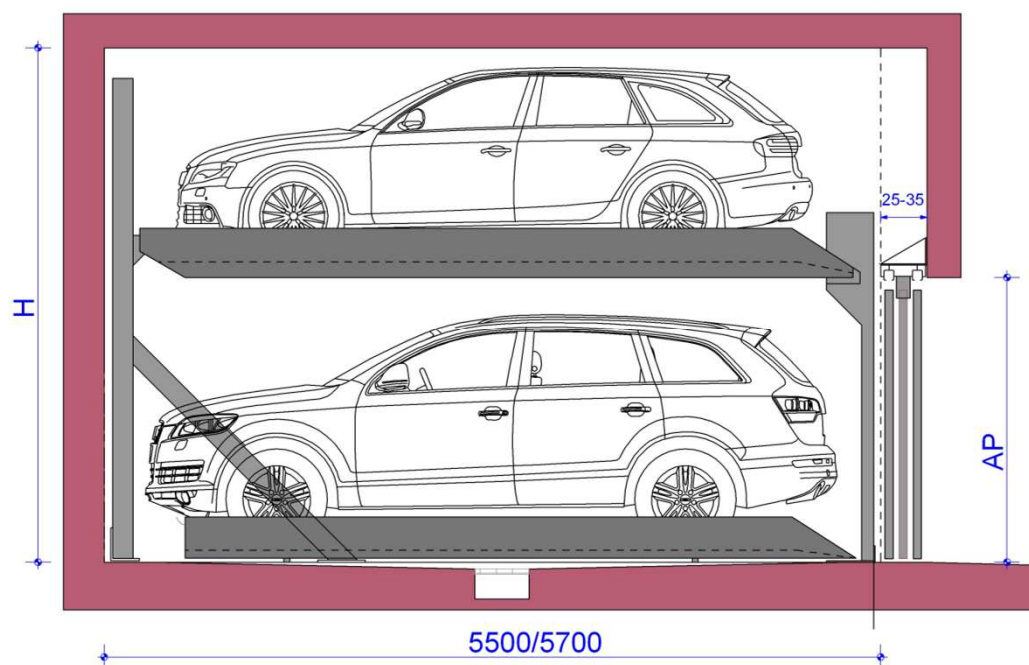

Model	H	AP	Car height entrance	Car height lower
PARK 02 – 160	3300	2200	1500	1500
PARK 02 – 175	3450	2200	1500	1650
PARK 02 – 180	3700	2300	1700	1700
PARK 02 – 185	3800	2200	1750	1750
PARK 02 – 210	4050	2300	1750	2000
PARK 02 – 215	4400	2300	2050	2050

PRODUCT DATA

PRODUCT DATA

DUO BOX Mod. PARK 02

Pit width	Usable entrance platform width	Usable lower platform width
2500	2200	2300
2600	2300	2400
2700	2400	2500
2800	2500	2600
2900	2600	2700

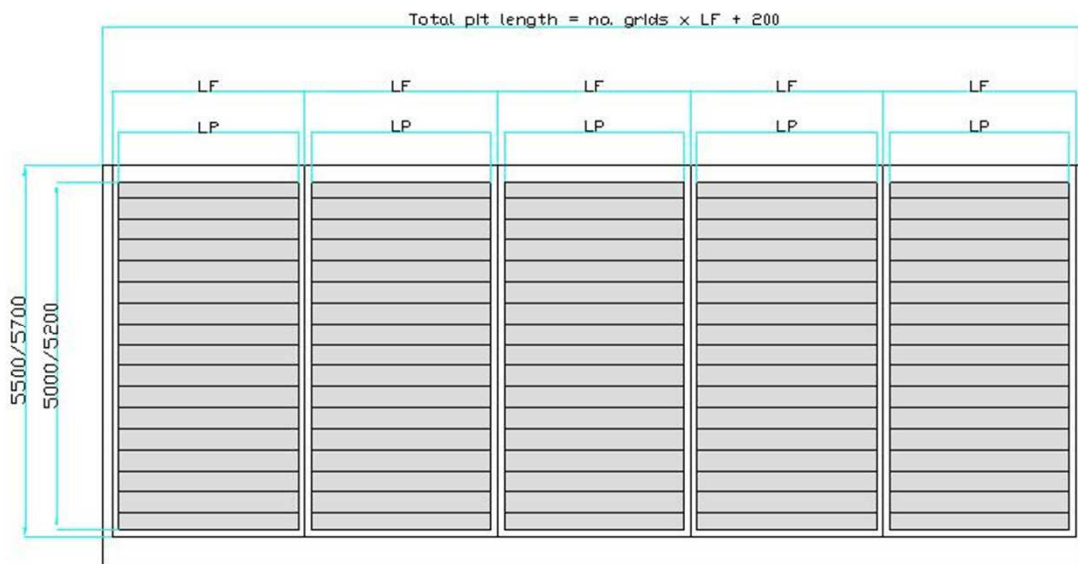

LF: Pit width
LP: Usable platform width

PHOTOS

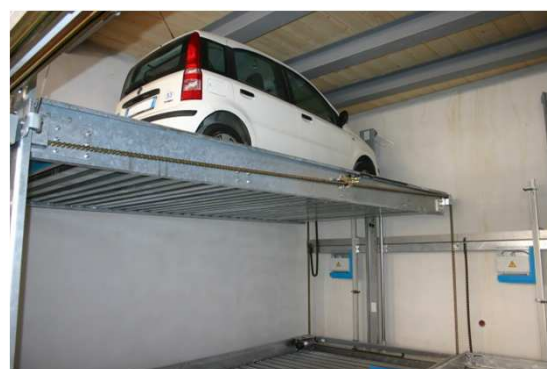
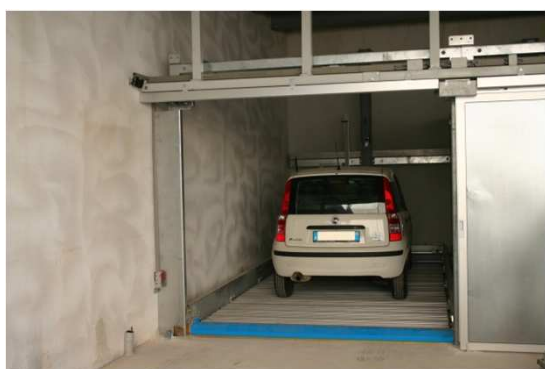
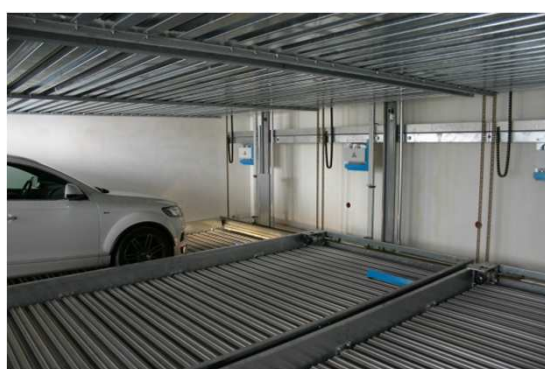

ACCESSORIES

